

Leveling Pads - Internal Thread

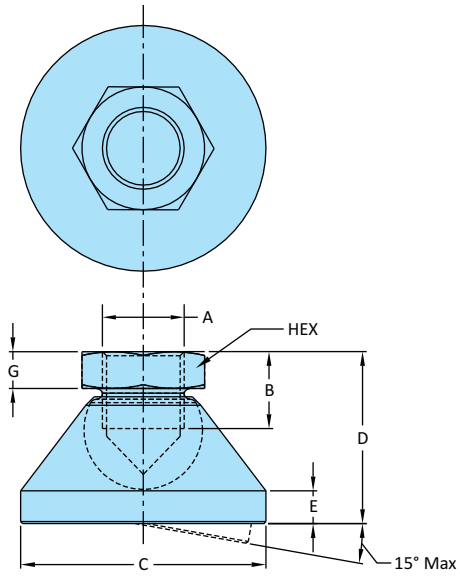

*Black Electro-Deposition Coating

Steel Version	Model No.	Weight Kgs	Max. Capacity for Static Load	Dimensions						
				A	B	C	D	E	G	HEX
Material Thrust Plate : Steel Ball Element : Steel Finish : Black ED* Coating	SLPF-624	0.017	10 kN	M6	5	20	14	2.5	8	10
	SLPF-825	0.036	18 kN	M8	7.0	25	18	4.0	8	13
	SLPF-1032	0.077	20 kN	M10	9.0	32	22	5.0	7	17
	SLPF-1240	0.125	35 kN	M12	11.0	40	26	6.0	7	19
	SLPF-1650	0.250	45 kN	M16	13.5	50	32	7.0	8	24
	SLPF-2060	0.480	55 kN	M20	17.0	60	42	8.0	10	30
	SLPF-2460	0.665	65 kN	M24	19.0	60	45	9.5	10	36

Stainless Steel Version	Model No.	Weight Kgs	Max. Capacity for Static Load	Dimensions						
				A	B	C	D	E	G	HEX
Material Thrust Plate : Stainless Steel-304 Ball Element : Stainless Steel-304 Finish : Electro-Polished	SLPF-624-SS	0.017	10 kN	M6	5	20	14	2.5	8	10
	SLPF-825-SS	0.036	18 kN	M8	7.0	25	18	4.0	8	13
	SLPF-1032-SS	0.077	20 kN	M10	9.0	32	22	5.0	7	17
	SLPF-1240-SS	0.125	35 kN	M12	11.0	40	26	6.0	7	19
	SLPF-1650-SS	0.250	45 kN	M16	13.5	50	32	7.0	8	24
	SLPF-2060-SS	0.480	55 kN	M20	17.0	60	42	8.0	10	30
	SLPF-2460-SS	0.665	65 kN	M24	19.0	60	45	9.5	10	36