

Non-Swivel Leveling Pads - External Thread

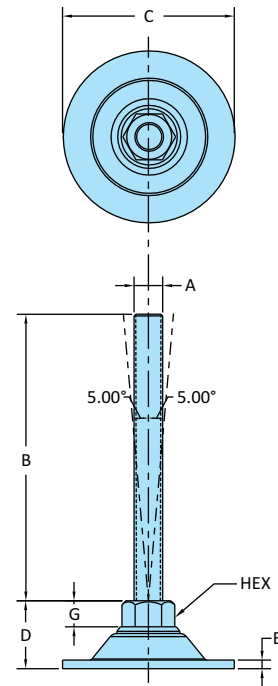

Also Available in Nickel Plated Option

Steel Version	Model No.	Weight Kgs	Max. Capacity for Static Load	Dimensions						
				A	B	C	D	E	G	HEX
Material Thrust Plate : Steel Stud : Steel Washer : Steel Finish : White Zinc Plating	SLPM-SM-60-1068	0.134	15 kN	M10	68	60	24	3	10	16
	SLPM-SM-60-10100	0.150	15 kN	M10	100	60	24	3	10	16
	SLPM-SM-60-1268	0.152	15 kN	M12	68	60	24	3	10	16
	SLPM-SM-60-1280	0.161	15 kN	M12	80	60	24	3	10	16
	SLPM-SM-60-12100	0.177	15 kN	M12	100	60	24	3	10	16
	SLPM-SM-60-12150	0.206	15 kN	M12	150	60	24	3	10	16
	SLPM-SM-60-1668	0.199	25 kN	M16	68	60	24	3	10	19
	SLPM-SM-60-16100	0.243	25 kN	M16	100	60	24	3	10	19
	SLPM-SM-60-16150	0.300	25 kN	M16	150	60	24	3	10	19
	SLPM-SM-60-16160	0.315	25 kN	M16	160	60	24	3	10	19

Stainless Steel Version	Model No.	Weight Kgs	Max. Capacity for Static Load	Dimensions						
				A	B	C	D	E	G	HEX
Material Thrust Plate : Stainless Steel-304 Stud : Stainless Steel-304 Washer : Stainless Steel-304 Finish : Electro-Polished	SLPM-SM-60-1068-SS	0.138	15 kN	M10	68	60	24	3	10	16
	SLPM-SM-60-10100-SS	0.154	15 kN	M10	100	60	24	3	10	16
	SLPM-SM-60-1268-SS	0.156	15 kN	M12	68	60	24	3	10	16
	SLPM-SM-60-1280-SS	0.165	15 kN	M12	80	60	24	3	10	16
	SLPM-SM-60-12100-SS	0.181	15 kN	M12	100	60	24	3	10	16
	SLPM-SM-60-12150-SS	0.211	15 kN	M12	150	60	24	3	10	16
	SLPM-SM-60-1668-SS	0.211	25 kN	M16	68	60	24	3	10	19
	SLPM-SM-60-16100-SS	0.203	25 kN	M16	100	60	24	3	10	19
	SLPM-SM-60-16150-SS	0.306	25 kN	M16	150	60	24	3	10	19
	SLPM-SM-60-16160-SS	0.319	25 kN	M16	160	60	24	3	10	19