

VTC-Series

Medium Duty Clamps-Straight Base

The **SF Series** have a solid hold down bar which has a fixed guide bush at its end for the spindle assembly.

The **SB Series** have a 'U' bar arm which the bolt retainer can be welded at any desired angle.

The **UB Series** have a 'U' bar arm which enables one or more spindles to be moved into any desired position along the arm.

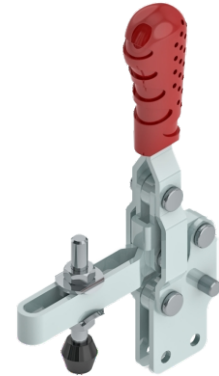
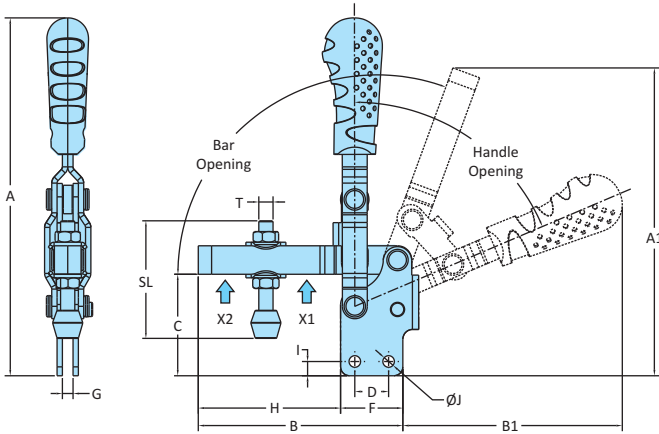
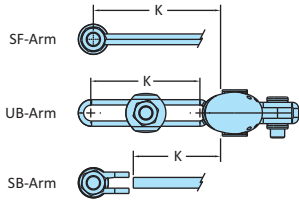

Model No.VTC-3670-UB-BS

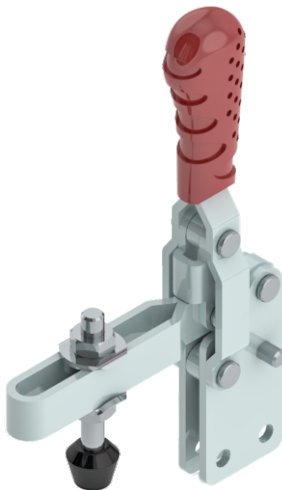

Model No.VTC-4595-UB-BS

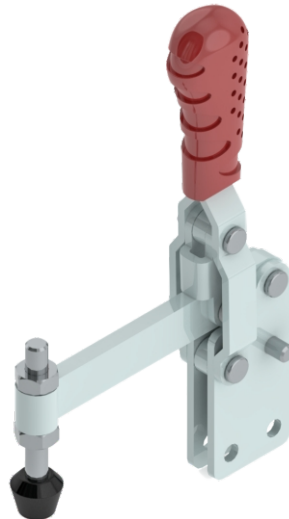

Model No.VTC-4595-SF-BS

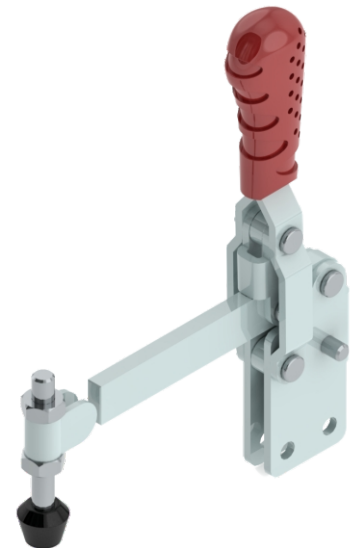

Model No.VTC-4595-SB-BS

Model No.	Material	Finish	Arm Type	Base Type	Supplied With		Holding Capacity	
					Spindle Assembly	Washers	X2	X1
VTC-2535-UB-BS	Steel	Zinc Plated	Adjustable Arm	Straight Base	RT-645-2N2W	M6-WSHR	0.50 kN	1.00 kN
VTC-2535-SF-BS	Steel	Zinc Plated	Spindle Fixed	Straight Base	RT-645-2N	-	0.50 kN	-
VTC-2535-SB-BS	Steel	Zinc Plated	Solid Arm	Straight Base	RT-645-2N	-	0.50 kN	1.00 kN
VTC-3670-UB-BS	Steel	Zinc Plated	Adjustable Arm	Straight Base	RT-865-2N2W	M8-WSHR	1.00 kN	2.00 kN
VTC-3670-SF-BS	Steel	Zinc Plated	Spindle Fixed	Straight Base	RT-865-2N	-	1.00 kN	-
VTC-3670-SB-BS	Steel	Zinc Plated	Solid Arm	Straight Base	RT-865-2N	-	1.00 kN	2.00 kN
VTC-4595-UB-BS	Steel	Zinc Plated	Adjustable Arm	Straight Base	RT-1085-2N2W	M10-WSHR	2.00 kN	3.90 kN
VTC-4595-SF-BS	Steel	Zinc Plated	Spindle Fixed	Straight Base	RT-1085-2N	-	2.00 kN	-
VTC-4595-SB-BS	Steel	Zinc Plated	Solid Arm	Straight Base	RT-1085-2N	-	2.00 kN	3.90 kN

Model No.	Weight Kgs	Handle Opening	Bar Opening	Dimensions													
				A	A1	B	B1	C	D	E	F	G	H	J	K	T	SL
VTC-2535-UB-BS	0.220	64°	104°	140	110	75	82	36	15	7	30	6	45	5.5	32	M6	46
VTC-2535-SF-BS	0.220	64°	104°	140	109.5	74	82	36	15	7	30	6	44	5.5	38	M6	46
VTC-2535-SB-BS	0.220	64°	104°	140	104	72	82	36	15	7	30	6	42	5.5	42	M6	46
VTC-3670-UB-BS	0.420	67°	110°	201	173	115	123	57	19	8	35	6	80	6.5	61	M8	66
VTC-3670-SF-BS	0.420	67°	110°	201	173	115	123	57	19	8	35	6	80	6.5	73	M8	66
VTC-3670-SB-BS	0.420	67°	110°	201	161	102	123	57	19	8	35	6	67	6.5	67	M8	66
VTC-4595-UB-BS	0.820	72°	120°	235	212	151	133	75	25	11	45	8	106	8.5	79	M10	86
VTC-4595-SF-BS	0.820	72°	120°	235	212	151	133	75	25	11	45	8	106	8.5	97	M10	86
VTC-4595-SB-BS	0.820	72°	120°	235	203	141	133	75	25	11	45	8	96	8.5	97	M10	86