

Vertical Hold Down Action-International Range

The all new international equivalent range of toggle clamps from Steel-Smith. Now all the leading international toggle clamps have their equivalents in this range. What's more, these quality clamps come with hardened bushes for enhanced life, several safety features and slicker finish.

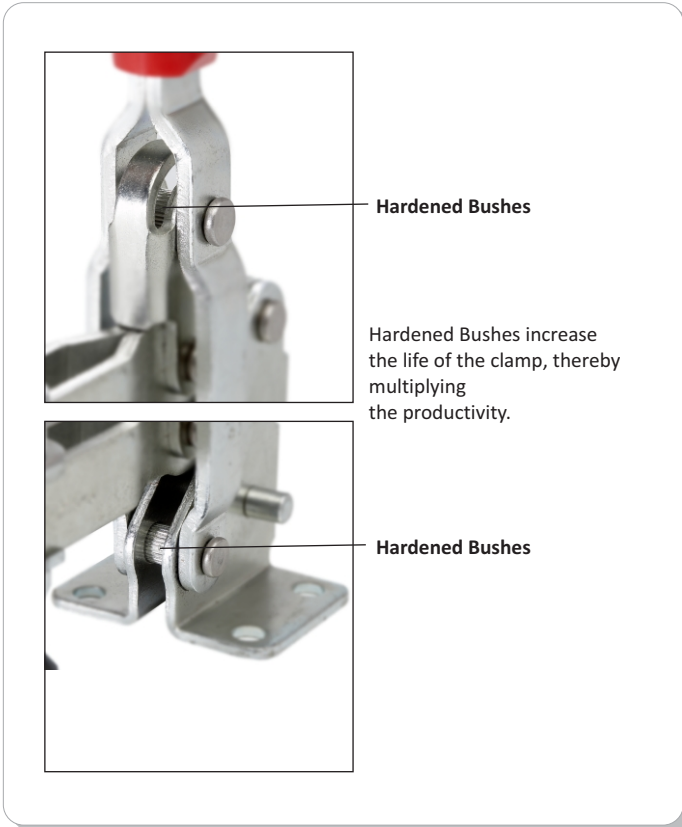

*This feature protects the user's finger from accidentally entering the clamp linking and getting injured during clamping operations.*

Vertical Hold Down Action  
VTC-201 Series

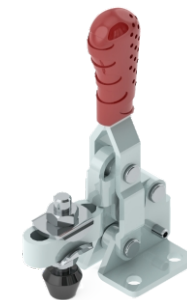
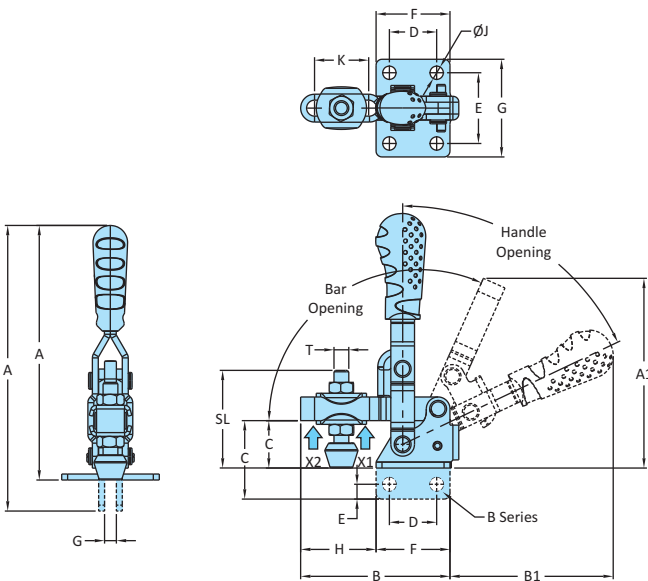

Model No. VTC-201-U

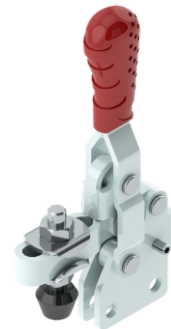

Model No. VTC-201-UB

Model No.	Material	Finish	Arm Type	Base Type	Supplied With		Holding Capacity	
					Spindle Assembly	Washers	X2	X1
VTC-201-U	Steel	Zinc Plated	Adjustable Arm	Flanged Base	RT-533-2N2W	M5-WSHR	0.24 kN	0.50 kN
VTC-201-UB	Steel	Zinc Plated	Adjustable Arm	Straight Base	RT-533-2N2W	M5-WSHR	0.24 kN	0.50 kN
VTC-201-U-SS	Stainless Steel-304	Electro Polishing	Adjustable Arm	Flanged Base	RT-533-2N2W-SS	M5-WSHR-SS	0.24 kN	0.50 kN
VTC-201-UB-SS	Stainless Steel-304	Electro Polishing	Adjustable Arm	Straight Base	RT-533-2N2W-SS	M5-WSHR-SS	0.24 kN	0.50 kN

Model No.	Weight Kgs	Handle Opening	Bar Opening	Dimensions													
				A	A1	B	B1	C	D	E	F	G	H	J	K	T	SL
VTC-201-U	0.080	65°	114°	86	64	50.5	55	16	16	23.9	25	33	25.5	4.5	18.3	M5	33
VTC-201-UB	0.080	65°	114°	96.5	74.5	50.5	55	26.5	16	5	25	4	25.5	4.5	18.3	M5	33
VTC-201-U-SS	0.080	65°	114°	86	64	50.5	55	16	16	23.9	25	33	25.5	4.5	18.3	M5	33
VTC-201-UB-SS	0.080	60°	114°	96.5	74.5	50.5	55	26.5	16	5	25	4	25.5	4.5	18.3	M5	33