

Medium Duty
Non-Adjustable Latch

| | |
|--------------------|---------------------|
| Model No | PAH-30-502 |
| Weight | 0.100 Kgs |
| Holding Capacity | X - 4.40 kN |
| Material | Steel |
| Finish | Zinc Plated |
| Supplied with Hook | FH-01-502 |
| Model No | PAH-30-502-SS |
| Material | Stainless Steel-304 |
| Supplied with Hook | FH-01-502-SS |



Medium Duty
Non-Adjustable Latch Padlockable

| | |
|--------------------|---------------------|
| Model No | PAH-30-570 |
| Weight | 0.100 Kgs |
| Holding Capacity | X - 4.40 kN |
| Material | Steel |
| Finish | Zinc Plated |
| Supplied with Hook | FH-01-502 |
| Model No | PAH-30-570-SS |
| Material | Stainless Steel-304 |
| Supplied with Hook | FH-01-502-SS |

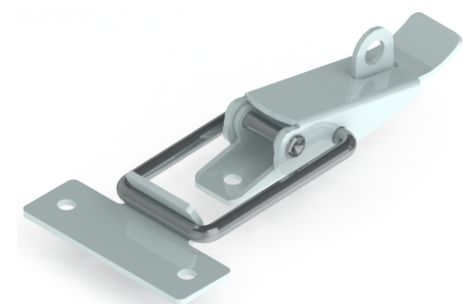

Medium Duty
Non-Adjustable Latch

| | |
|--------------------|---------------------|
| Model No | PAH-30-588-LP |
| Weight | 0.110 Kgs |
| Holding Capacity | X - 4.40 kN |
| Material | Steel |
| Finish | Zinc Plated |
| Supplied with Hook | FH-01-502 |
| Model No | PAH-30-588-LP-SS |
| Material | Stainless Steel-304 |
| Supplied with Hook | FH-01-502-SS |

