

H-Series
Miniature Clamps

| | |
|-------------------------------------|----------------|
| Model No | H-206-UB |
| Weight | 0.040 Kgs |
| Handle Opening ($\pm 3^\circ$) | 90° |
| Clamp Bar Opening ($\pm 3^\circ$) | 90° |
| Holding Capacity | X1 - 0.50 kN |
| | X2 - 0.20 kN |
| Material | Steel |
| Finish | Zinc Plated |
| Arm Type | Adjustable Arm |
| Base Type | Straight Base |
| Supplied with Spindle | RT-533-2N2W |

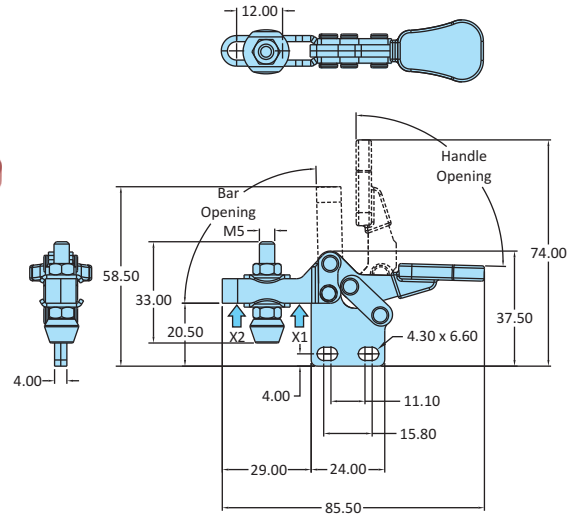
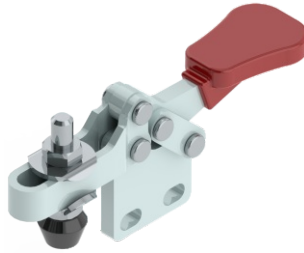

H-Series
Miniature Clamps

| | |
|-------------------------------------|---------------------|
| Model No | H-206-HU |
| Weight | 0.060 Kgs |
| Handle Opening ($\pm 3^\circ$) | 87° |
| Clamp Bar Opening ($\pm 3^\circ$) | 85° |
| Holding Capacity | X1 - 0.50 kN |
| | X2 - 0.20 kN |
| Material | Steel |
| Finish | Zinc Plated |
| Arm Type | High Adjustable Arm |
| Base Type | Flanged Base |
| Supplied with Spindle | RT-539-2N2W |

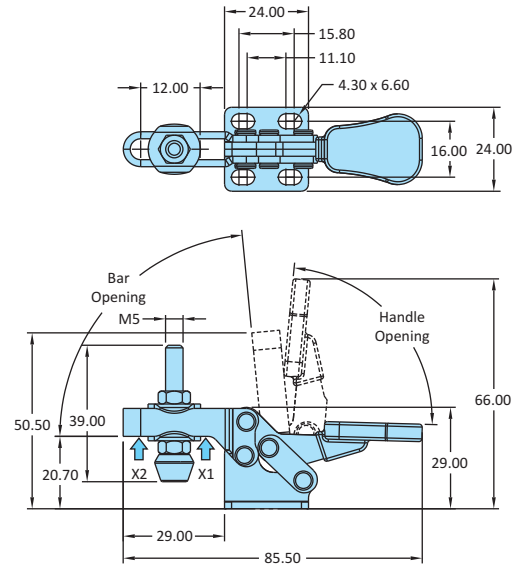
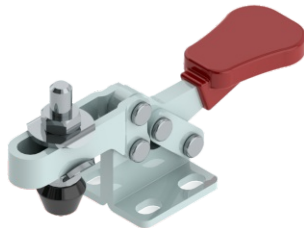

H-Series
Miniature Clamps

| | |
|-------------------------------------|---------------------|
| Model No | H-206-HUB |
| Weight | 0.060 Kgs |
| Handle Opening ($\pm 3^\circ$) | 87° |
| Clamp Bar Opening ($\pm 3^\circ$) | 85° |
| Holding Capacity | X1 - 0.50 kN |
| | X2 - 0.20 kN |
| Material | Steel |
| Finish | Zinc Plated |
| Arm Type | High Adjustable Arm |
| Base Type | Straight Base |
| Supplied with Spindle | RT-539-2N2W |

